

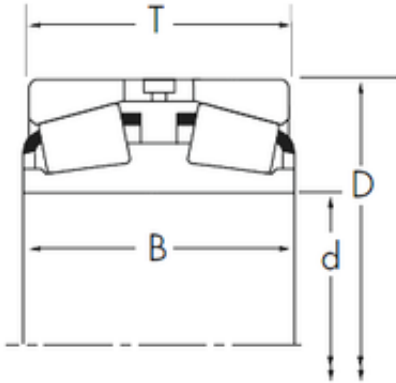

NTN Bearing Driveshaft USA CORP.

120,65 mm x 174,625 mm x 68,262 mm Timken
M224749D/M224710+M224710EA Tapered roller
bearings



Bearing No. M224749D/M224710+M224710EA

Size	120.65x174.625x66.678 mm
Bore Diameter	120,65 mm
Outer Diameter	174,625 mm
Width	66,678 mm
d	120,65 mm
D	174,625 mm
T	66,678 mm
B	68,262 mm
R	0,8 mm
r	1,5 mm

M224749D/M224710+M224710EA
drawings and 3D CAD models

Bearing 2D