

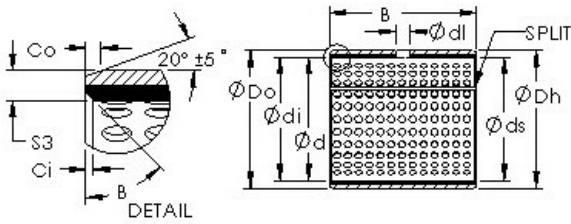

# NTN Bearing Driveshaft USA CORP.



## AST AST20 1015 Plain bearings

Bearing No. AST20 1015

Bore Diameter	10 mm
Outer Diameter	12 mm
Bearing Type	straight
Shaft Dia., Nominal (d)	10.0000
Shaft Size (ds) - 10 +0 / -0.022	10 +0 / 0.022
Housing Bore Dia. (Dh) - 12 +0.018 / -0	12 +0.018 / 0
Bearing Outside Diameter, Nominal(Do)	12.000
Bearing Outside Diameter Tolerance (Do tol.)	12.065 / 12.030
Bearing Bore after Mounting (di)	10.108 / 10.040
Average Clearance (Cd)	0.0850
Wall Thickness (S3)	0.968
Bearing Length, Nominal (B)	15.000
Bearing Length Tolerance (B tol.) - +0 / -0.40	+0 / 0.40
OD Chamfer Length (Co)	0.600
ID Chamfer Angle (B deg.)	30
ID Chamfer Length (Ci)	0.300
Lube Hole Dia. (dl)	4.000
Material	Carbon steel shell with POM plastic liner

AST20 1015 Bearing 2D drawings and 3D CAD models