

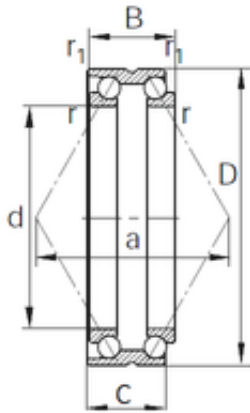

NTN Bearing Driveshaft USA CORP.



165 mm x 210 mm x 52 mm KBC SDA0102
Angular contact ball bearings

Bearing No. SDA0102

Size	165x210x52 mm
Bore Diameter	165 mm
Outer Diameter	210 mm
Width	52 mm
d	165 mm
D	210 mm
B	52 mm
C	47.5 mm
Angle (°)	30 °
a	82.5 mm
r min.	1.1 mm
r1 min.	1.1 mm
Basic dynamic load rating (C)	118 kN

SDA0102 Bearing 2D drawings and 3D CAD models